

FIREMASTER®/FIREMASTER® PLUS² FIRE CURTAIN WITH SMOKE SEAL HEADBOX CONFIGURATION SECTIONS

FM 15/20/SS
FMP 15/20/SS

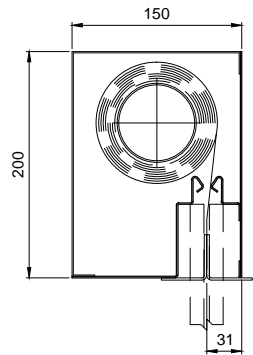

FM 18/22/SS
FMP 18/22/SS

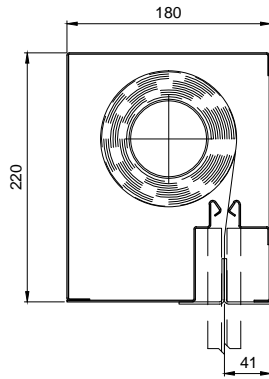

FM 18/26/SS
FMP 18/26/SS

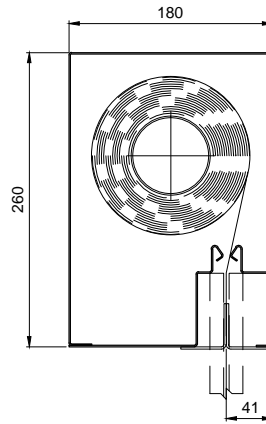

FM 25/30/SS
FMP 25/30/SS

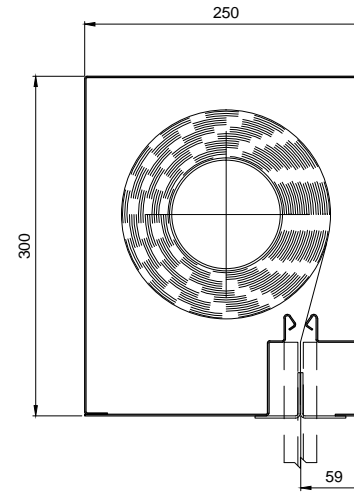

FMP 30/34/SS

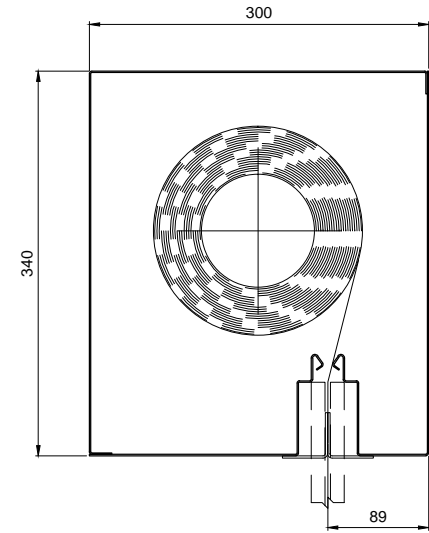

Product	Max Width	Max Drop	Fabric
FM	5 metres	3.5 metres	EFP™ A1
FMP	4 metres	2.5 metres	EFP™ 2/1000/DGI

Product	Max Width	Max Drop	Fabric
FM	5 metres	4.5 metres	EFP™ A1
FMP	4 metres	3.0 metres	EFP™ 2/1000/DGI

Product	Max Width	Max Drop	Fabric
FM	5 metres	6.0 metres	EFP™ A1
FMP	4 metres	4.0 metres	EFP™ 2/1000/DGI

Product	Max Width	Max Drop	Fabric
FM	5 metres	6.0 metres	EFP™ A1
FMP	4 metres	6.0 metres	EFP™ 2/1000/DGI

Product	Max Width	Max Drop	Fabric
FM	n/a	n/a	EFP™ A1
FMP	4 metres	8.0 metres	EFP™ 2/1000/DGI

FIREMASTER® PLUS² FIRE CURTAIN WITH SMOKE SEAL WIDE SINGLE ROLLER (WSR) HEADBOX SECTIONS

WSR 23/25/SS

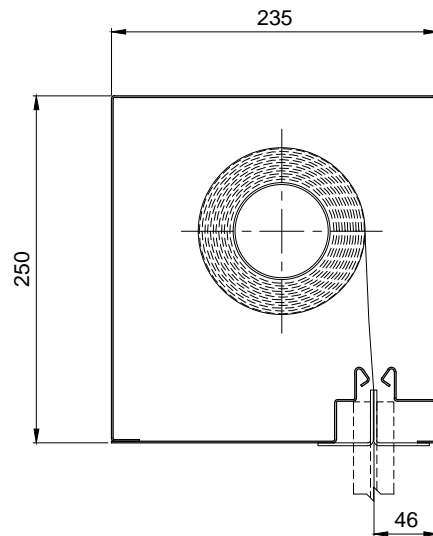

FABRIC TYPE	WIDTH		DROP		SEAM
	MIN	MAX	MIN	MAX	
EFPTM 2/1000 DGI	1M	10M	1M	4M	Horizontal

WSR 25/30/SS

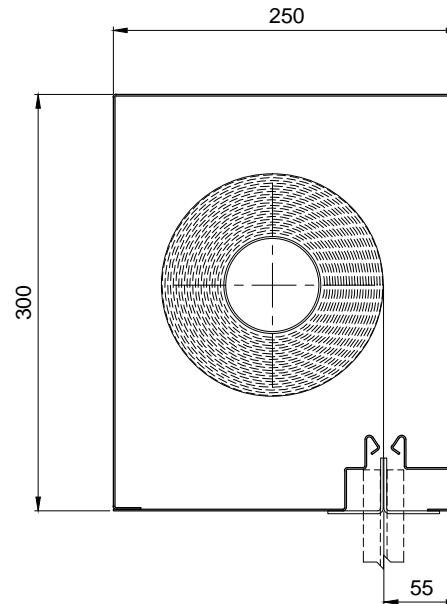

FABRIC TYPE	WIDTH		DROP		SEAM
	MIN	MAX	MIN	MAX	
EFPTM 2/1000 DGI	1M	17M	1M	4M	Horizontal
EFPTM 2/1000 DGI	1M	7M	1M	5M	Vertical

Note: Over 5M drop additional assessment is required

WSR 30/34/SS

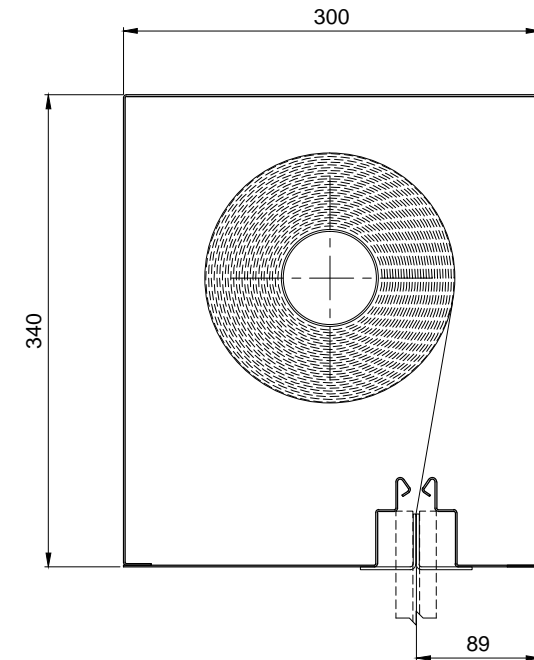

FABRIC TYPE	WIDTH		DROP		SEAM
	MIN	MAX	MIN	MAX	
EFPTM 2/1000 DGI	1M	20M	1M	4M	Horizontal
EFPTM 2/1000 DGI	1M	7M	1M	5M	Vertical

Note: Over 5M drop additional assessment is required

FIREMASTER®/FIREMASTER® PLUS² SIDE GUIDE WITH SMOKE SEAL FIXING CONFIGURATION

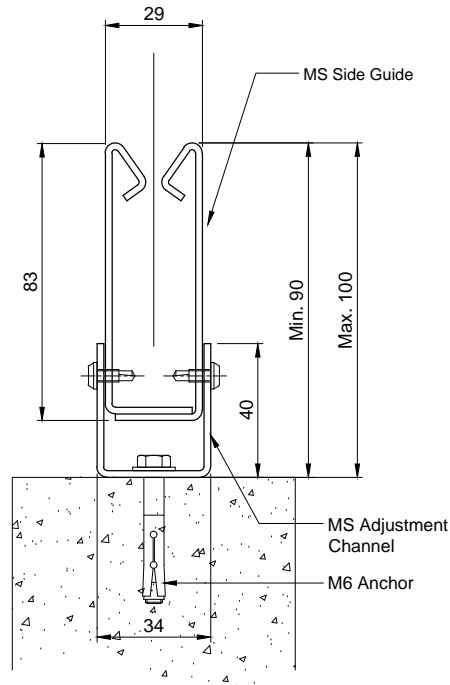

SIDE MOUNTED
SIDE GUIDE DETAILS

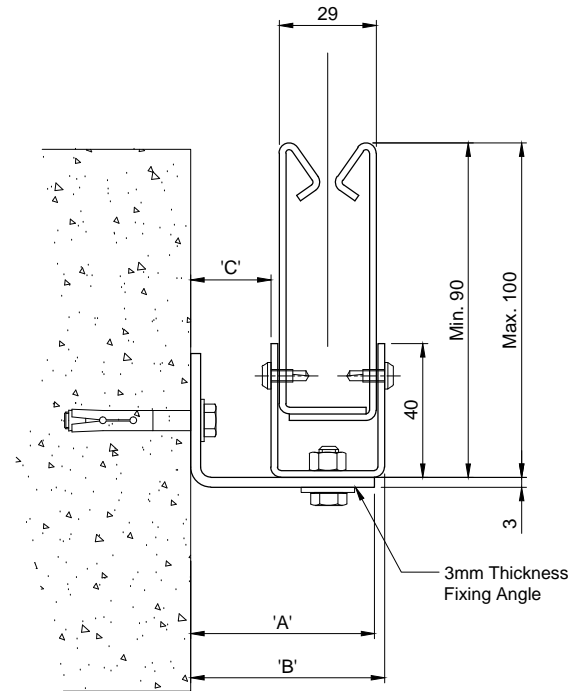

REVERSE MOUNTED (OPTION 1)
SIDE GUIDE DETAILS

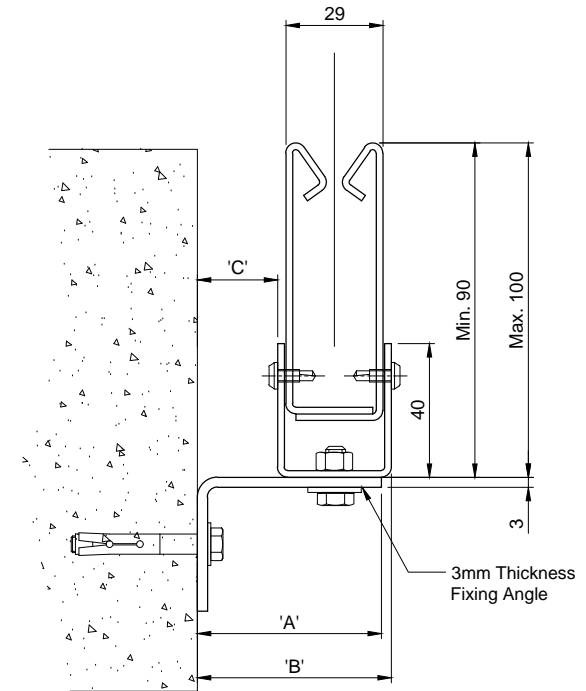

REVERSE MOUNTED (OPTION 2)
SIDE GUIDE DETAILS

FIXING DIMENSION

HEADBOX	'A'	'B'	'C'
FM15/20/SS & FMP15/20	45mm	48mm	15mm
FM18/22/SS & FMP18/22/SS	55mm	58mm	25mm
FM18/26/SS & FMP 18/26/SS	55mm	58mm	25mm
FM25/30/SS & FMP25/30/SS	72mm	75mm	42mm
FMP30/34/SS	102mm	105mm	72mm
83mm Side Guide applies to curtains under 6M drop			

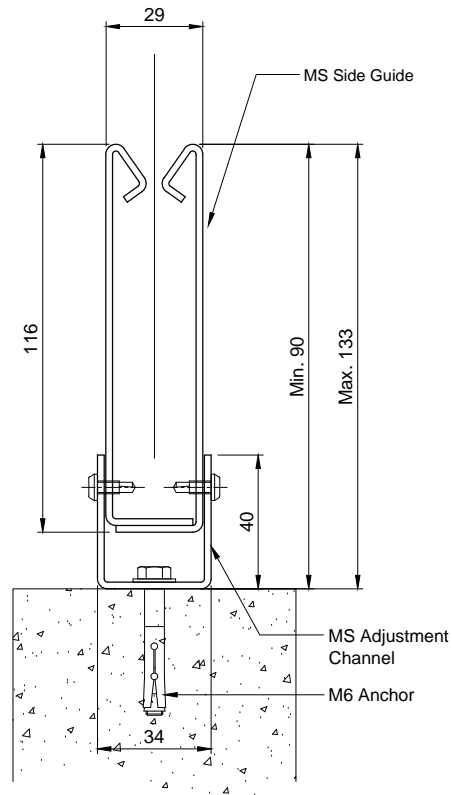

SIDE MOUNTED
SIDE GUIDE DETAILS

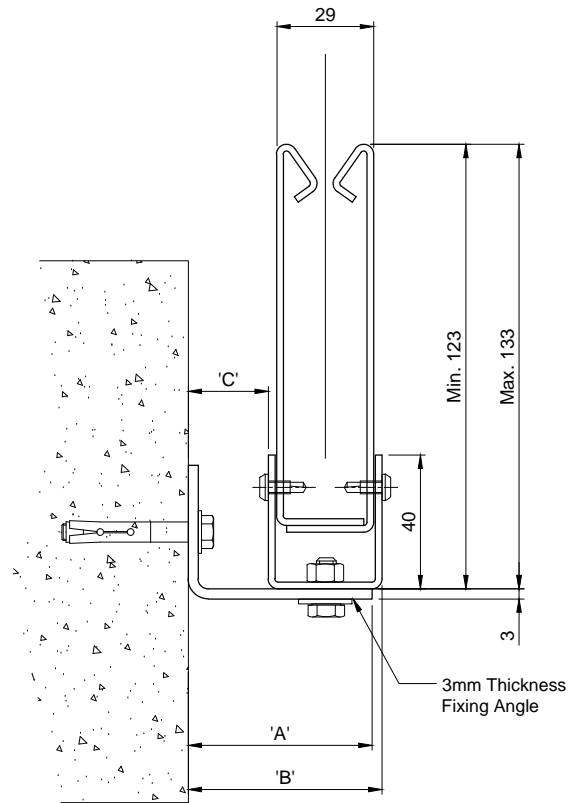

REVERSE MOUNTED (OPTION 1)
SIDE GUIDE DETAILS

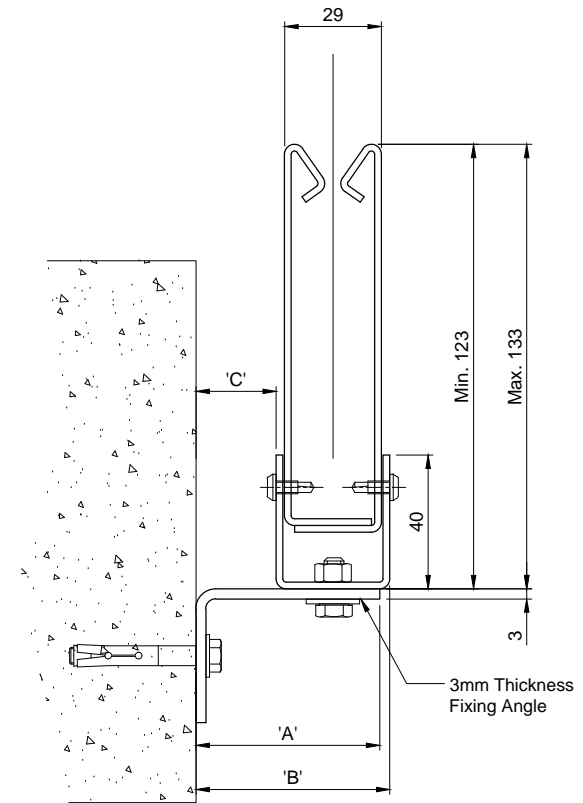

REVERSE MOUNTED (OPTION 2)
SIDE GUIDE DETAILS

DRAWN:	TITLE:		
ML	116mm FireMaster® Plus ² Side Guide Fixing Configuration		
CHECKED:	© 1997-2018 COOPERS FIRE LIMITED ALL RIGHTS RESERVED. THIS DESIGN MAY NOT BE REPRODUCED IN ANY MATERIAL FORM, INCLUDING ELECTRONICALLY WITHOUT THE WRITTEN PERMISSION OF THE COPYRIGHT NAMES		
JR	ALL DIMENSIONS IN MILLIMETRES UNLESS OTHERWISE STATED		
APPROVED:	DRG. No.	ISSUE:	1
JR	607/037//MK	DATE:	04.07.2018

FIXING DIMENSION			
HEADBOX	'A'	'B'	'C'
FMP25/20	72mm	75mm	42mm
FMP30/34	102mm	105mm	72mm
116mm Side Guide applies to curtains over 6M drop			

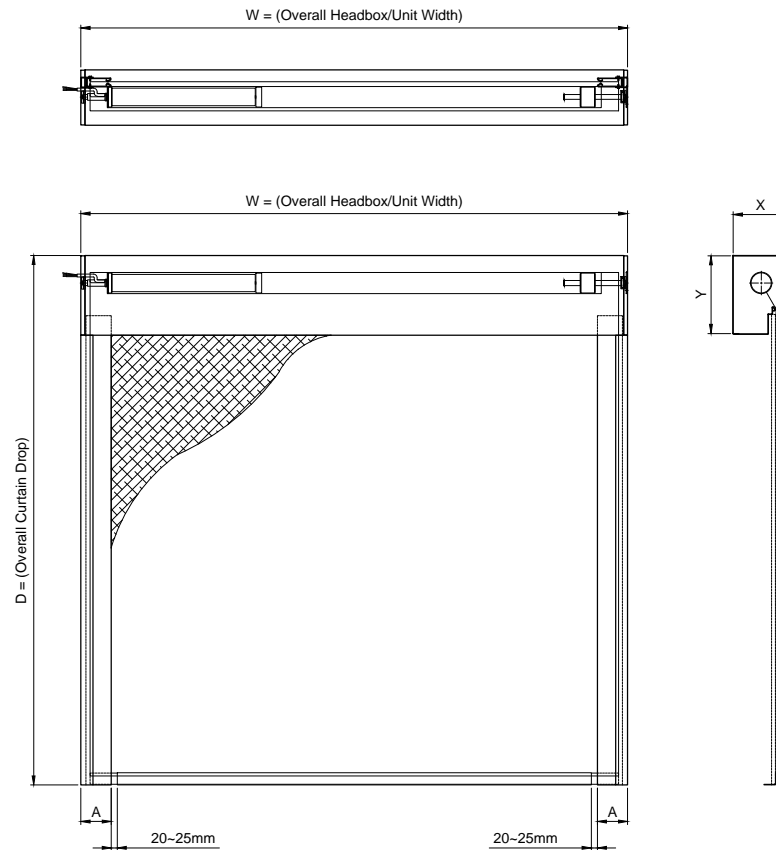

HEADBOX		OVERALL DIMENSION		
X (mm)	Y (mm)	W	D	A (mm)
150	200	< 4m	< 2.5m	90 - 100
180	220	< 4m	< 3.0m	90 - 100
180	260	< 4m	< 4.0m	90 - 100
250	300	< 4m	< 6.0m	90 - 100
300	340	< 4m	< 8.0m	123 - 133

DRAWN:	TITLE: FireMaster® Plus² with Smoke Seal Matrix of Sizes (EFP™ 2/1000/DGI) - Tbar	
ML		
CHECKED:	© 1997-2018 COOPERS FIRE LIMITED ALL RIGHTS RESERVED. THIS DESIGN MAY NOT BE REPRODUCED IN ANY MATERIAL FORM, INCLUDING ELECTRONICALLY WITHOUT THE WRITTEN PERMISSION OF THE COPYRIGHT NAMES	ALL DIMENSIONS IN MILLIMETRES UNLESS OTHERWISE STATED
JR		
APPROVED:	DRG. No. 607/044/MK	ISSUE: 1 DATE: 04.07.2018
JR		

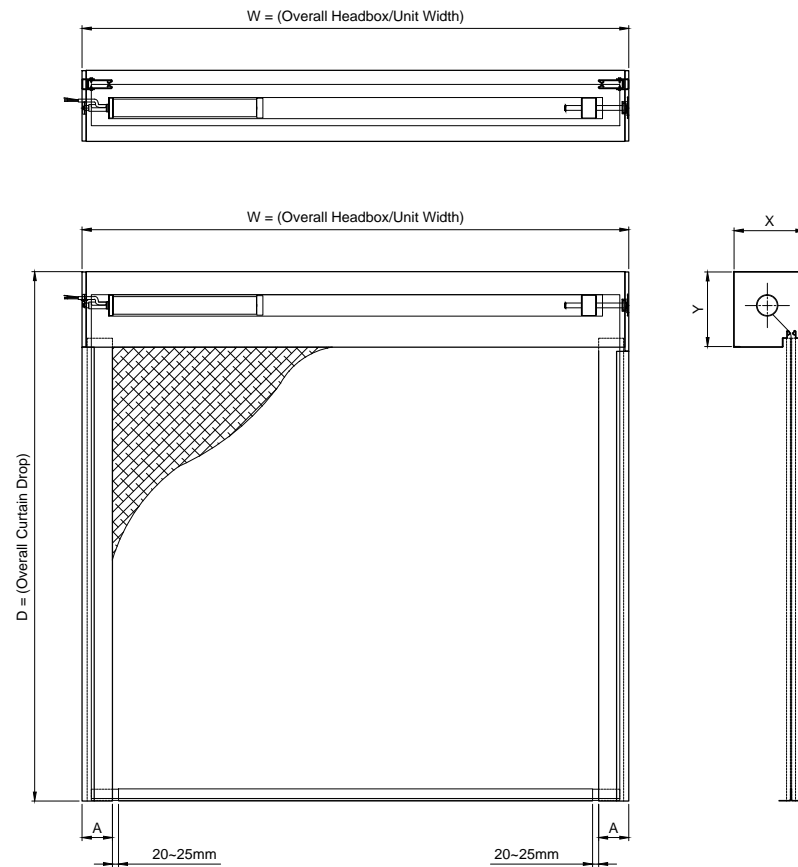

HEADBOX		OVERALL DIMENSION		
X (mm)	Y (mm)	W	D	A (mm)
235	250	< 10m	< 4.0m	90 - 100
250	300	< 17m	< 4.0m	90 - 100
		< 7m	< 5.0m	90 - 100
300	340	< 20m	< 4.0m	90 - 100
		< 7m	< 5.0m	90 - 100

Note: Over 5M drop additional assessment is required

DRAWN:	TITLE:		
ML	FireMaster® Plus² WSR (Smoke Seal) Matrix of Sizes (EFP™ 2/1000/DGI) - Tbar		
CHECKED:	© 1997-2018 COOPERS FIRE LIMITED ALL RIGHTS RESERVED. THIS DESIGN MAY NOT BE REPRODUCED IN ANY MATERIAL FORM, INCLUDING ELECTRONICALLY WITHOUT THE WRITTEN PERMISSION OF THE COPYRIGHT NAMES		
JR	ALL DIMENSIONS IN MILLIMETRES UNLESS OTHERWISE STATED		
APPROVED:	DRG. No.	ISSUE:	1
JR	602/163/MK	DATE:	04.07.2018

NOTE: -
SIZES OUTSIDE THESE STANDARDS - PLEASE CONTACT COOPERS